



parts@globalplant.co.uk

Guidetti s.r.l.

MACCHINE E SISTEMI PER RICICLAGGIO
RECYCLING SYSTEMS AND MACHINERIES



SPARE PARTS BOOK

MEDIUM CRUSCHER

"MEF-520"

6a ed. – Maggio 2006

Via Salvi, 1 - 44045 Renazzo (FE) - ITALY - Tel. 051/972058 - 051/972070 - Fax 051/972099 - P.I. 01460390386 - C.F. 01720221207
Capitale Sociale € 102.960,00 i.v. - Iscr. Reg. Impr. FE n. 12771/1999 - R.E.A di Ferrara n.169899 - M. n. FE007582 Foro di competenza BO
e-mail: info@guidettirecyclingsrl.com - www.guidettirecyclingsrl.com

www.globalplant.co.uk



INTRODUCTION

This catalogue has been projected to be a guide for the order of spare parts and has been realized for a quick identification of the parts that constitute the machine. Instructions, drawings and all the other contents of this catalogue are technical and confidential. For this reason no data or information may be reproduced neither entirely nor partially without written authorization from Guidetti S.r.L.

Guidetti represents the sole owner and reserves all rights to modify the catalogue without prior warning.

INDEX	PAG. 02
FLOATING UNIT	PAG. 03
MACHINE BODY UNIT	PAG. 04
PULLEY UNIT	PAG. 05
ISUZU ENGINE UNIT	PAG. 06
UNDER CARRIAGE UNIT	PAG. 07
GRANULOMETRY REGULATION UNIT	PAG. 08
HOPPER UNIT	PAG. 09
MAGNETIC SEPARATOR UNIT (OPTION)	PAG. 10
CONVEYOR BELT UNIT	PAG. 11
TANKS UNIT	PAG. 12
ELECTRIC PANEL UNIT	PAG. 13
CARTER & COFFERS UNIT	PAG. 14

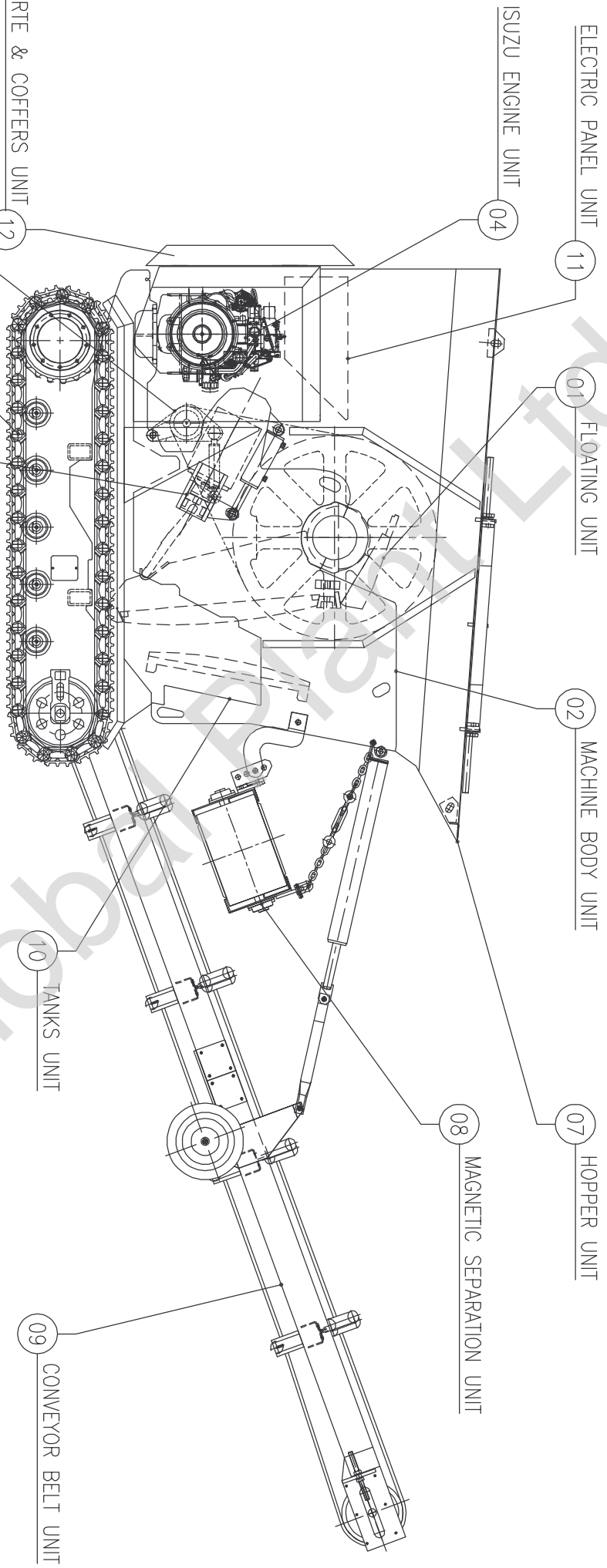

12	MEF.05.000	CARTE & COFFERS UNIT	1		
11	MEF.09.000	ELECTRIC PANEL UNIT	1		
10	MEF.18.000	TANKS UNIT	1		
09	MEF.15.000	CONVEYOR BELT UNIT	1		
08	MEF.14.000	MAGNETIC SEPARATOR UNIT	1		
07	MEF.13.000	HOPPER UNIT	1		
06	MEF.12.000	GRANULOMETRY REGULATION UNIT	1		
05	MEF.11.000	UNDER CARRIAGE UNIT	1		
04	MEF.08.000	ISUZU ENGINE UNIT	1		
03	MEF.04.000	PULLEY UNIT	1		
02	MEF.02.000	MACHINE BODY UNIT	1		
01	MEF.01.000	FLOATING UNIT	1		
POS.	REF.	DESCRIPTION	Q.TY		EURO

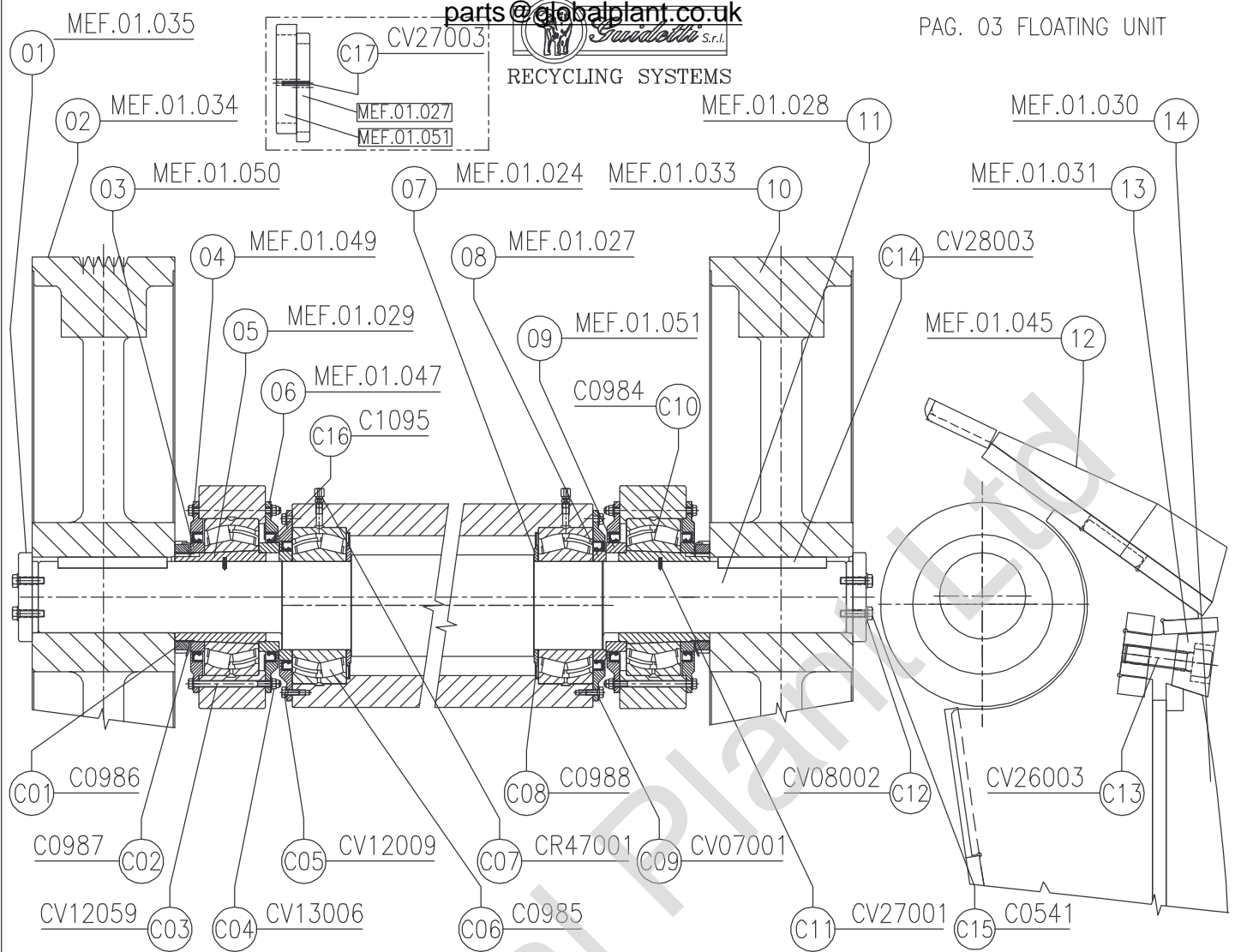

C17	CV27003	LIGHT ELASTIC PLUG 6x40 UNI 6	1		
C16	C1095	OIL SEAL	6		
C15	C0541	SCREW T.E. M10x40 UNI 5739	8		
C14	CV28003	TAB UNI 6604-A-28x16x160	2		
C13	CV26003	SCREW TCCE M.27x100 UNI 5931	3		
C12	CV08002	WASHER UNI 6798J 10x18	8		
C11	CV27001	ELASTIC PLUG D.5x16	2		
C10	C0984	BEARING 115X230X80	2		
C09	CV07001	FLAT WASHER UNI 6592B 8.4x17	24		
C08	C0988	OIL SEAL	2		
C07	CR47001	"OGIVA" CONNECTION	2		
C06	C0985	BEARING 115x230x80	2		
C05	CV12009	SCREW T.E. M8x20 UNI 5739	8		
C04	CV13006	WASHER AUTO.N M8 UNI ESNorm	8		
C03	CV12059	SCREW T.E. M8x130 UNI 5737	8		
C02	C0987	WASHER D.130 (MB 26)	2		
C01	C0986	RING NUT M. 130x2 (KM 26)	2		
14	MEF.01.030	MOBILE JAW	1		
13	MEF.01.031	BLOCKING WEDGE	3		
12	MEF.01.045	FLOATING UNIT	1		
11	MEF.01.028	FLOATING	1		
10	MEF.01.033	SMOOTH FLYWHEEL	1		
09	MEF.01.051	GAUGE SP. 30mm	2		
08	MEF.01.027	GAUGE SHAFT	2		
07	MEF.01.024	NILOS GAUGE	2		
06	MEF.01.047	PROTECTION BEARING	4		
05	MEF.01.029	TRACTION COMPASS	2		
04	MEF.01.049	PROTECTION BEARING	2		
03	MEF.01.050	RING NUT GAUGE	2		
02	MEF.01.034	FLYWHEEL WITH GROOVES	1		
01	MEF.01.035	FLYWHWLS-LOCKER www.globalplant.co.uk	2		

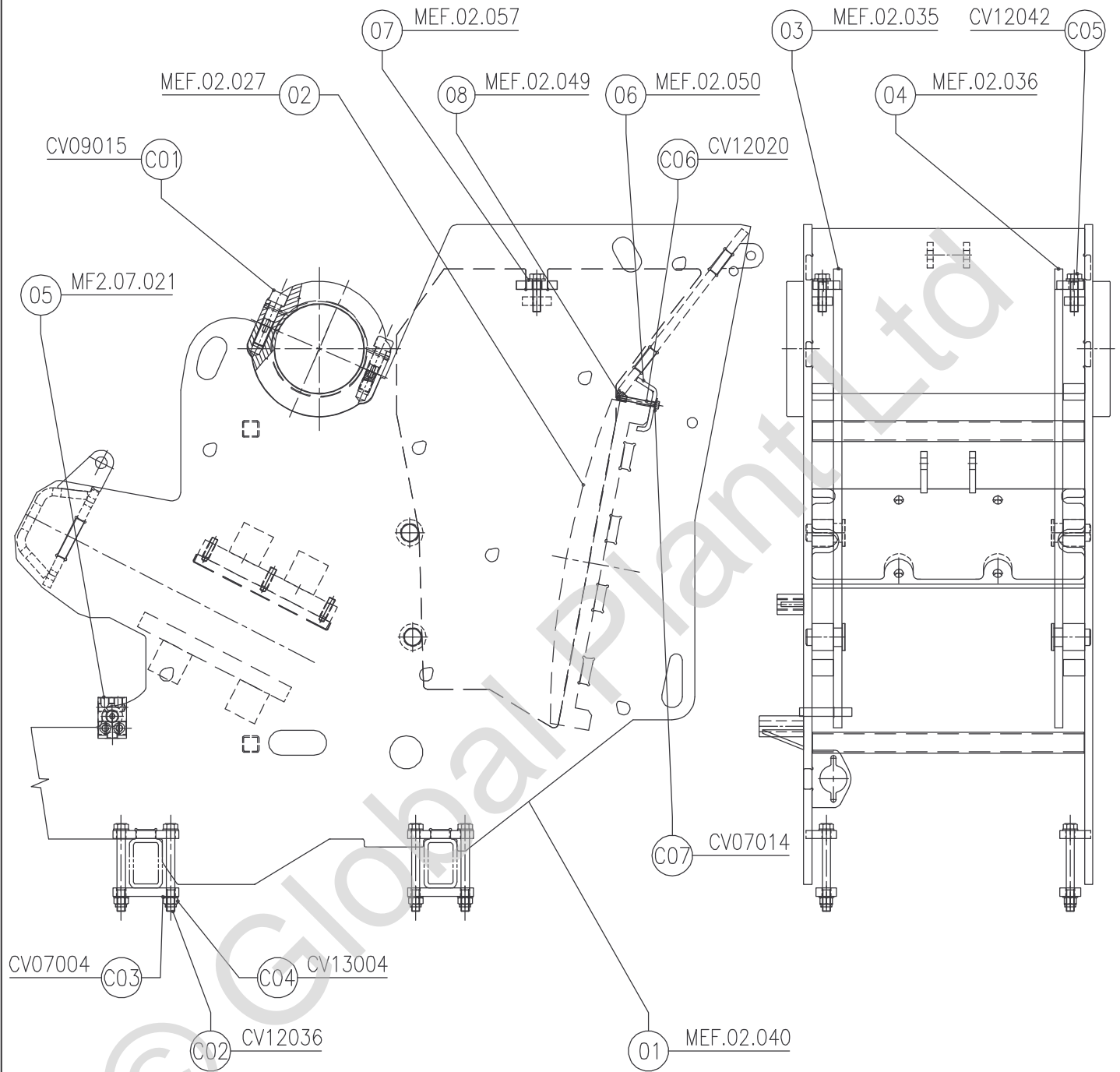

C07	CV07014	FLAT WASHER UNI 6593 11x30	10		
C06	CV12020	SCREW T.E. M10x90 UNI 5739	1		
C05	CV12042	SCREW T.E. M20x80 UNI 5739	6		
C04	CV13004	NUT AUTO. N M20 UNI ESNorm	13		
C03	CV07004	FLAT WASHER UNI 6592B 21x37	21		
C02	CV12036	SCREW T.E. M20x200 UNI 5739	8		
C01	CV09015	VITE T.C.E.I. M27x110 UNI 5931	4		
08	MEF.02.049	FIX JAW BLOCKING WEDGE	1		
07	MEF.02.057	ANTI-WEAR BLOCKING PLATE	2		
06	MEF.02.050	FIXING BRACKET	2		
05	MF2.07.021	RETURNS CUBIC DEVICE	1		
04	MEF.02.036	ANTI-WEAR LEFT PLATE	1		
03	MEF.02.035	ANTI-WEAR RIGHT PLATE	1		
02	MEF.02.027	FIX JAW	1		
01	MEF.02.040	MACHINE FRAME	1		

RECYCLING SYSTEMS

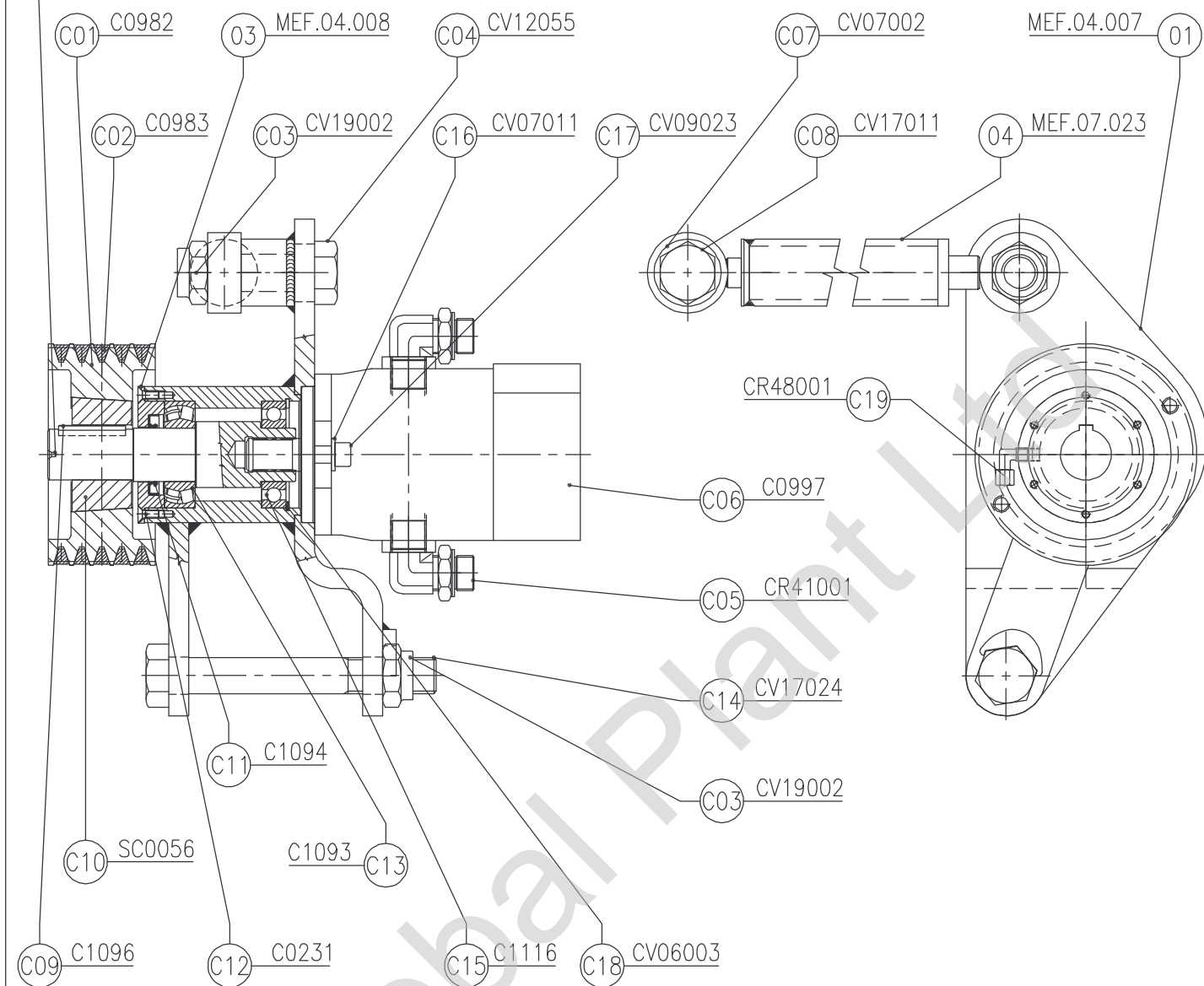

C19	CR48001	JOINT WITH OGIVE 90°	1		
C18	CV06003	SEEGER FOR INNER UNI 743	1		
C17	CV09023	SCREW T.C.E.I. M12x35 UNI 5931	2		
C16	CV07011	FLAT WASHER UNI 6592B 13x24	2		
C15	C1116	BEARING 6208 RAD. 1 Cor.	1		
C14	CV17024	SCREW T.E. M27*x200 UNI 5737	1		
C13	C1093	BEARING 22208 CC	1		
C12	C0231	SCREW T.S.E.I. M6x16 UNI 5933	6		
C11	C1094	STAYING RING 40x60x10	1		
C10	SC0056	CONIC COMPASS TIPO 2517	1		
C09	C1096	TAB UNI 6604-A-10x8x50	1		
C08	CV17011	SCREW T.E. M27*x90 UNI 5737	1		
C07	CV07002	FLAT WASHER UNI 6592B 28x50	2		
C06	C0997	HYDRAULIC ENGINE M4MF46-40 1B	1		
C05	CR41001	JOINT (FOR) A207029	3		
C04	CV12055	SCREW T.E. M27*x100 UNI 5737	1		
C03	CV19002	SELF-BLOCKING NUT M27*	2		
C02	C0983	COURRIE TRAP. TIP SPA 4000 MC	5		
C01	C0982	TRAP. PULLEY FOR COMPASS	1		
04	MEF.07.023	CYLINDER FOR BELTS'TENSION	1		
03	MEF.04.008	PROTECTION FOR PULLEY SUPPORT	1		
02	MEF.04.004	SHAFT FOR PULLEY SUPPORT	1		
01	MEF.04.007	ENGINE SUPPORT	1		

RECYCLING SYSTEMS

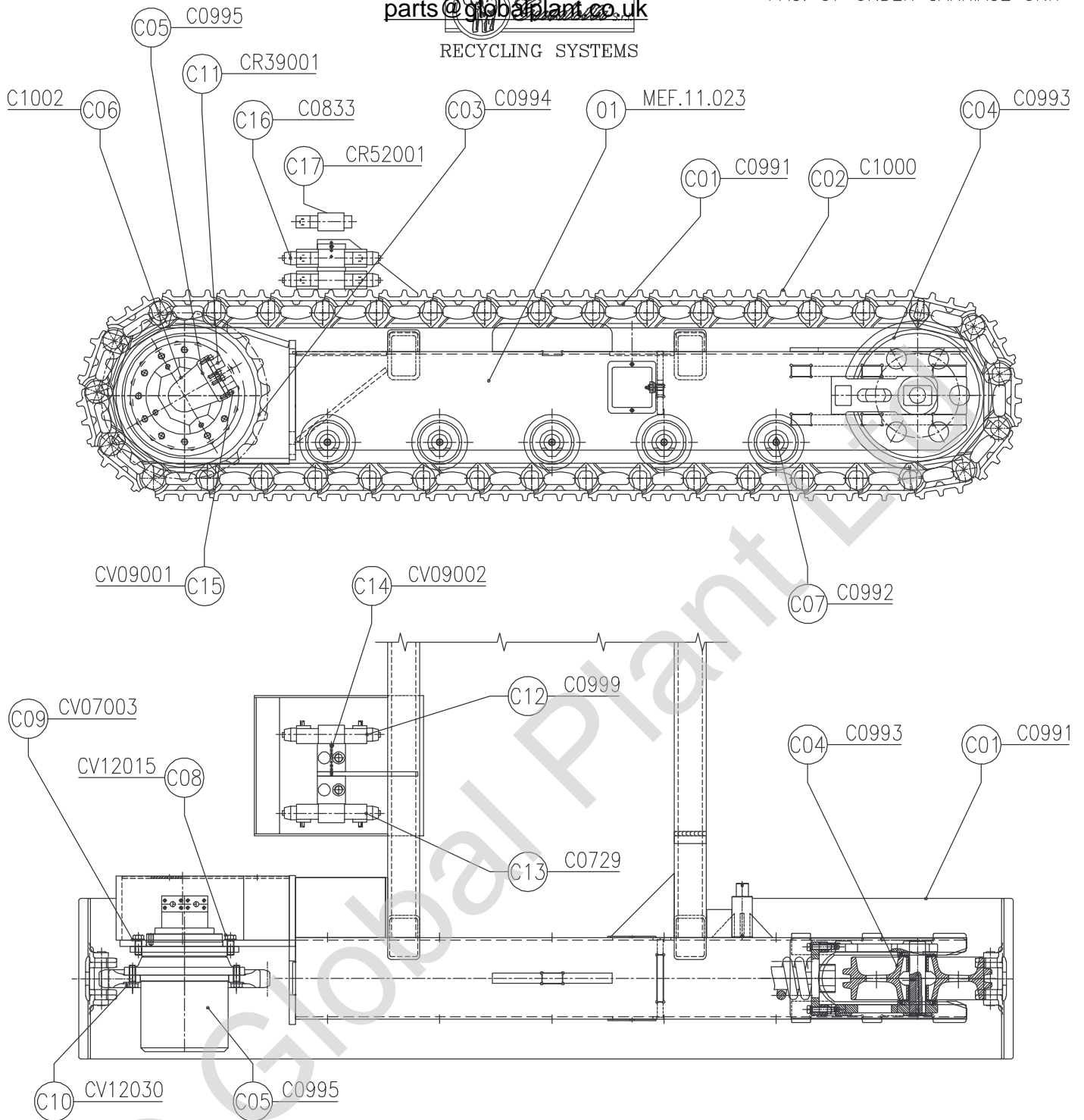

C17	CR52001	MAXIM VALVE	1		
C16	C0833	ELECTRO-VALVE MD1D.S1/50	6		
C15	CV09001	SCREW T.C.E.I. M8x25 UNI 5931	16		
C14	CV09002	SCREW T.C.E.I. M5x70 UNI 5931	4		
C13	C0729	PARALLEL CYLINDER BLOCK	1		
C12	C0999	CYLINDER BLOCK VMP A 4 S	1		
C11	CR39001	FLANGE "SAE 6000" 1/2"	4		
C10	CV12030	VITE T.E. M16x45 UNI 5739	32		
C09	CV07003	FLAT WASHER UNI 6592B 17x30	76		
C08	CV12015	SCREW T.E. M16x40 UNI 5739	24		
C07	C0992	LOWER ROLLER MU 5003 A	10		
C06	C1002	EPCYCL-ENGINE REDUCTOR	2		
C05	C0995	ENGINE REDUCTOR	2		
C04	C0993	WHEEL MU5013 A	2		
C03	C0994	MOTOR WHEEL Z=19 MU 5160	2		
C02	C1000	RUBBER/STEEL TRACKS (OPTION)	2		
C01	C0991	STEEL TRACK MU5026A/36/400	2		
O1	MEF.11.023	TRACKS' FRAME	1		

RECYCLING SYSTEMS

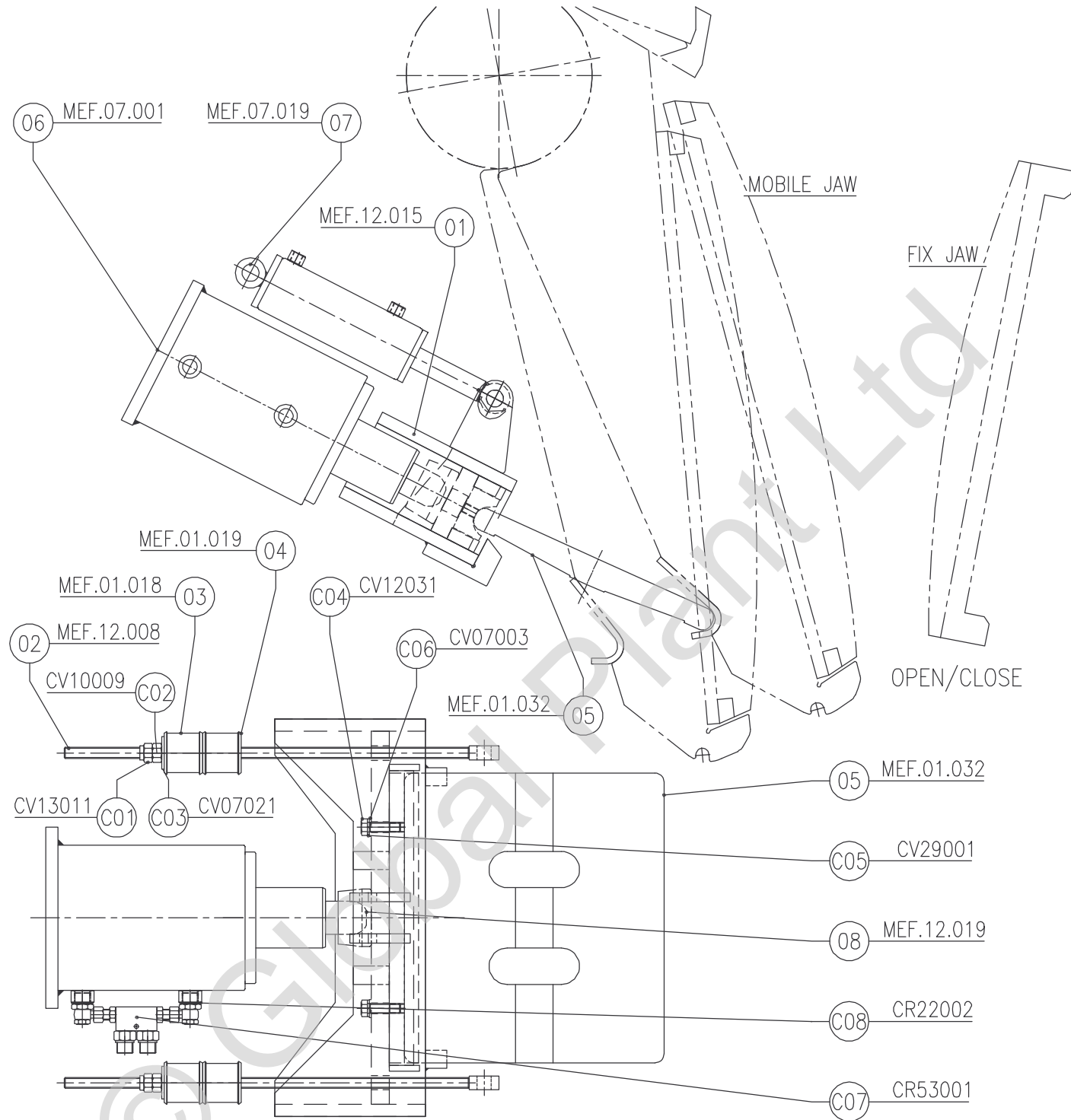

C08	CR22002	WASHER BONDED 3/4"	4		
C07	CR53001	PRESSURE REDUCTION VALVE	1		
C06	CV07003	FLAT WASHER UNI 6592B 17x30	2		
C05	CV29001	WASHER UNI 1751 A 16	2		
C04	CV12031	SCREW T.E. M16x55 UNI 5739	2		
C03	CV07021	ROSETTA PIANA UNI 6593 20x54	2		
C02	CV10009	NUT M18* UNI 5588	1		
C01	CV13011	NUT M18* UNI ESNorm	1		
08	MEF.12.019	CYLINDER CONNECTION	1		
07	MEF.07.019	AUXILIARY CYLINDER	1		
06	MEF.07.001	CYLINDER FOR REGULATION GRAN.	1		
05	MEF.01.032	TOGGLE	1		
04	MEF.01.019	WASHER FOR TIE ROD	8		
03	MEF.01.018	RUBBER DAMPER	4		
02	MEF.12.008	TIE ROD	2		
01	MEF.12.015	REGULATION GROUP UNIT	1		

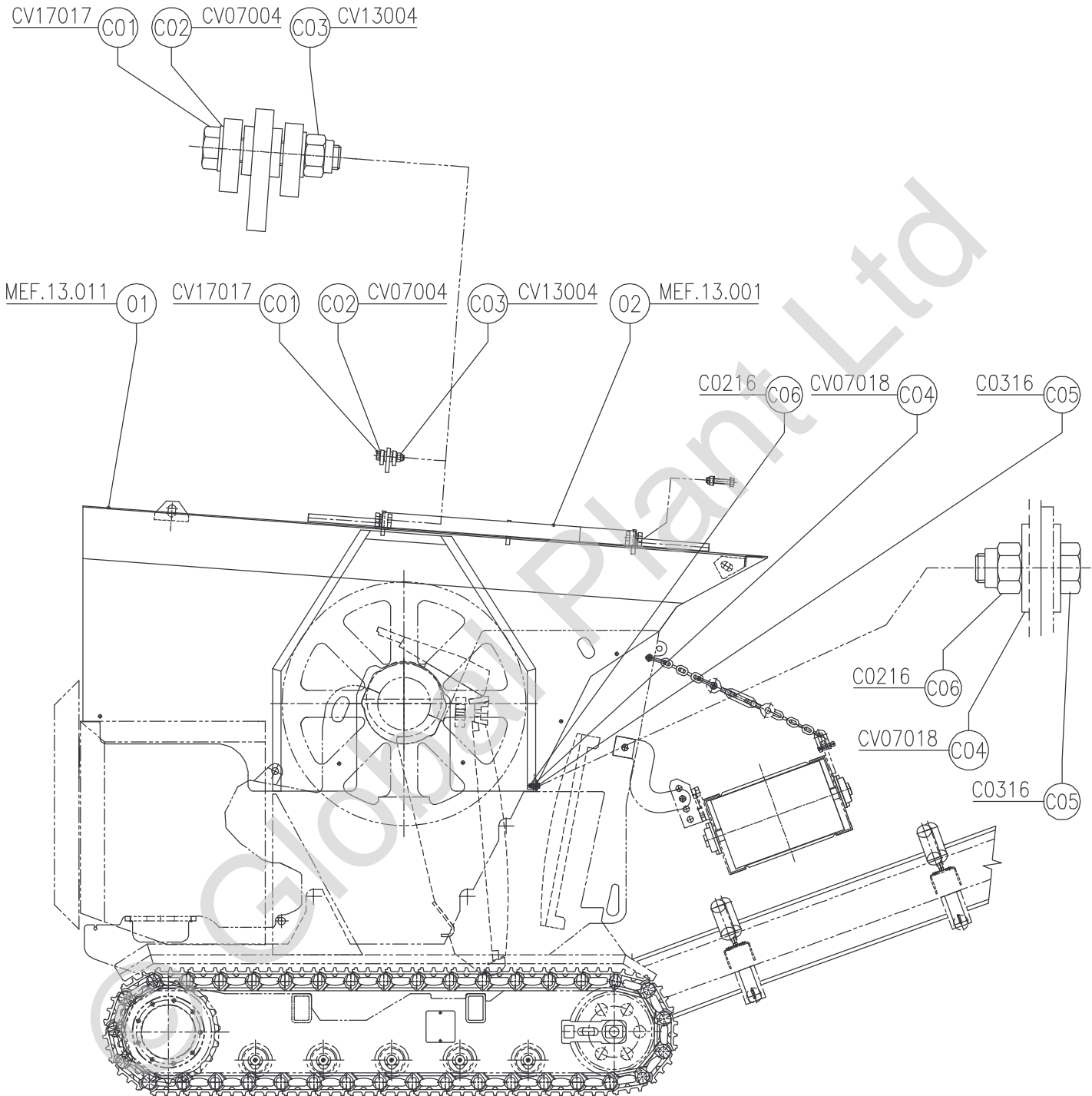

C06	C0216	NUT M12 UNI ESNorm	14		
C05	C0316	SCREW T.E. M12x35 UNI 5739	22		
C04	CV07018	FLAT WASHER UNI 6593 14x36	36		
C03	CV13004	NUT M20 UNI ESNorm	2		
C02	CV07004	FLAT WASHER UNI 6592B 21x37	4		
C01	CV17017	SCREW T.E. M20x100 UNI 5739	2		
02	MEF.13.001	GRID FRAME	1		
01	MEF.13.011	HOPPER FRAME	1		
000	000	DESCRIPTION	QTY		GROUP

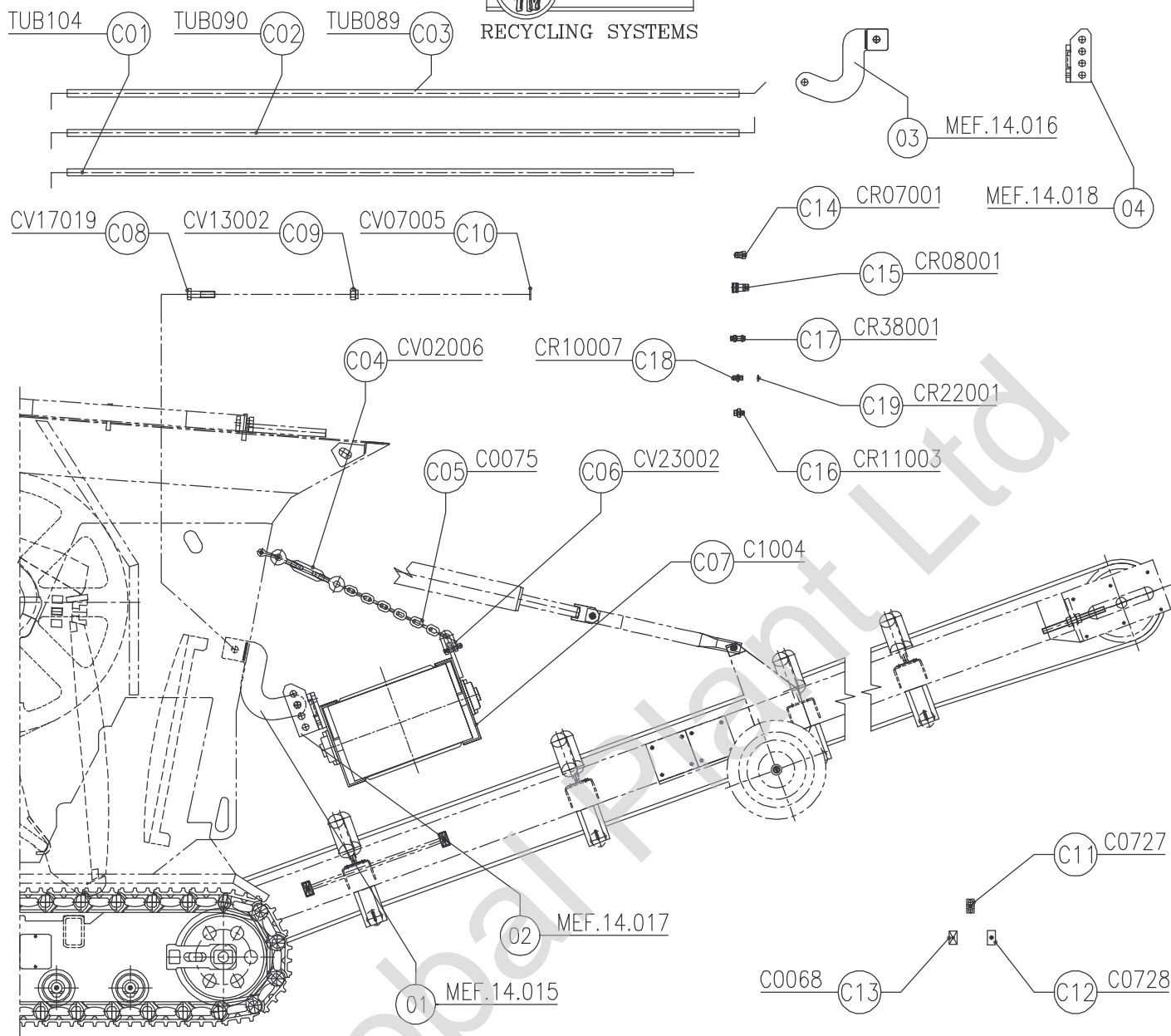

C19	CR22001	WASHER BONDED 3/8"	2		
C18	CR10007	CYLINDRICAL MALE NIPPLES 3/8	2		
C17	CR38001	NIPPLE WITH NUT 3/8	2		
C16	CR11003	REDUCTION NIPPLE 1/2 - 3/8	2		
C15	CR08001	FAST FEMALE CONNECTION	2		
C14	CR07001	FAST MALE CONNECTION	2		
C13	C0068	IRON PLATE FOR COLLAR	3		
C12	C0728	HIGHER PLATE FOR COLLAR	3		
C11	C0727	DOUBLE NYLON COLLAR FOR PIPE	3		
C10	CV07005	FLAT WASHER UNI 6592B 25x44	8		
C09	CV13002	NUT M24 UNI ESNorm	4		
C08	CV17019	SCREW T.E. M24x90 UNI 5737	4		
C07	C1004	OVERBELT (SMO 16.52.42)	1		
C06	CV23002	GALVANISED ROBUR M.12	6		
C05	C0075	GALVANISED CHAIN	1		
C04	CV02006	TURNBUCKLE ø16	2		
C03	TUB089	PIPE 3/8" R2T_C90 3/8"+C45 3/8	1		
C02	TUB090	PIPE 3/8" R2T_C90 3/8"+C90 3/8	1		
C01	TUB104	PIPE 3/8" R2T_C90 3/8"+FD 3/8"	2		
04	MEF.14.018	ADJUSTING BRACKET UNIT	1		
03	MEF.14.016	REGULATION BRACKET UNIT	1		
02	MEF.14.017	REGULATION BRACKET UNIT (RIGHT	1		
01	MEF.14.015	BRACKET UNIT FOR CONVEYOR BELT	1		

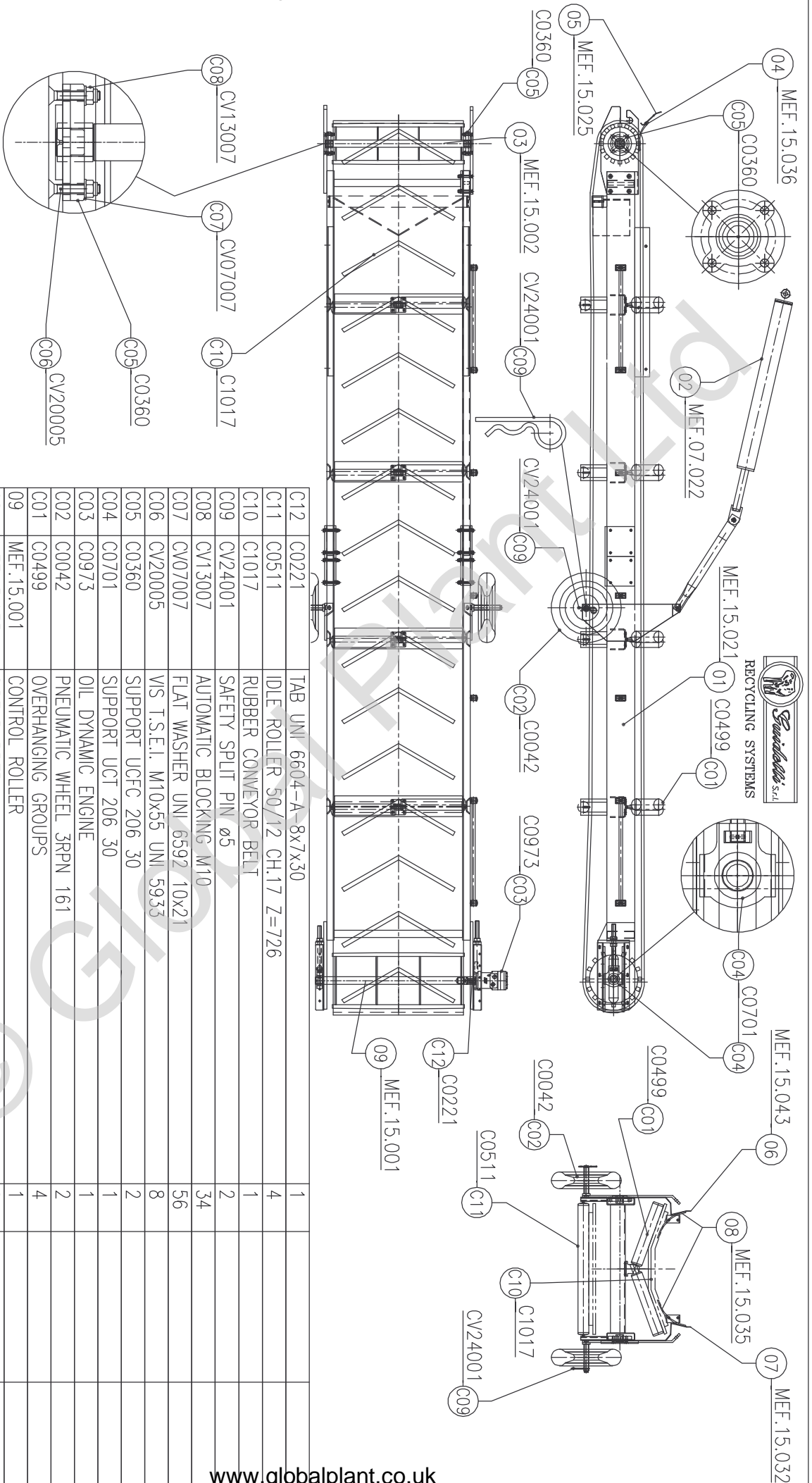

C12	C0221	TAB UNI. 6604-A-8x7x30	1	
C11	C0511	IDLE ROLLER 50/12 CH.17 Z=726	4	
C10	C1017	RUBBER CONVEYOR BELT	1	
C09	CV24001	SAFETY SPLIT PIN ø5	2	
C08	CV13007	AUTOMATIC BLOCKING M10	34	
C07	CV07007	FLAT WASHER UNI. 6592 10x21	56	
C06	CV20005	VIS T.S.E.I. M10x55 UNI 5933	8	
C05	C0360	SUPP0RT UCFC 206 30	2	
C04	C0701	SUPP0RT UCT 206 30	1	
C03	C0973	OIL DYNAMIC ENGINE	1	
C02	C0042	PNEUMATIC WHEEL 3RPN 161	2	
C01	C0499	OVERHANGING GROUPS	4	
09	MEF.15.001	CONTROL ROLLER	1	
08	MEF.15.035	SIDE RUBBER	2	
07	MEF.15.032	SX CONVEYOR BELT SIDE-PLATE	1	
06	MEF.15.043	DX BELT-SIDE UNIT	1	
05	MEF.15.025	SPONDA POSTERIORE PROTEZIONE	1	
04	MEF.15.036	REAR SIDE RUBBER	1	
03	MEF.15.002	IDLE ROLLER	1	
02	MEF.07.022	CYLINDER FOR CONVEYOR BELT	1	
01	MEF.15.021	CONVEYOR BELT FRAME	1	
POS.	REF.	DESCRIPTION	Q.TY	EURO

RECYCLING SYSTEMS

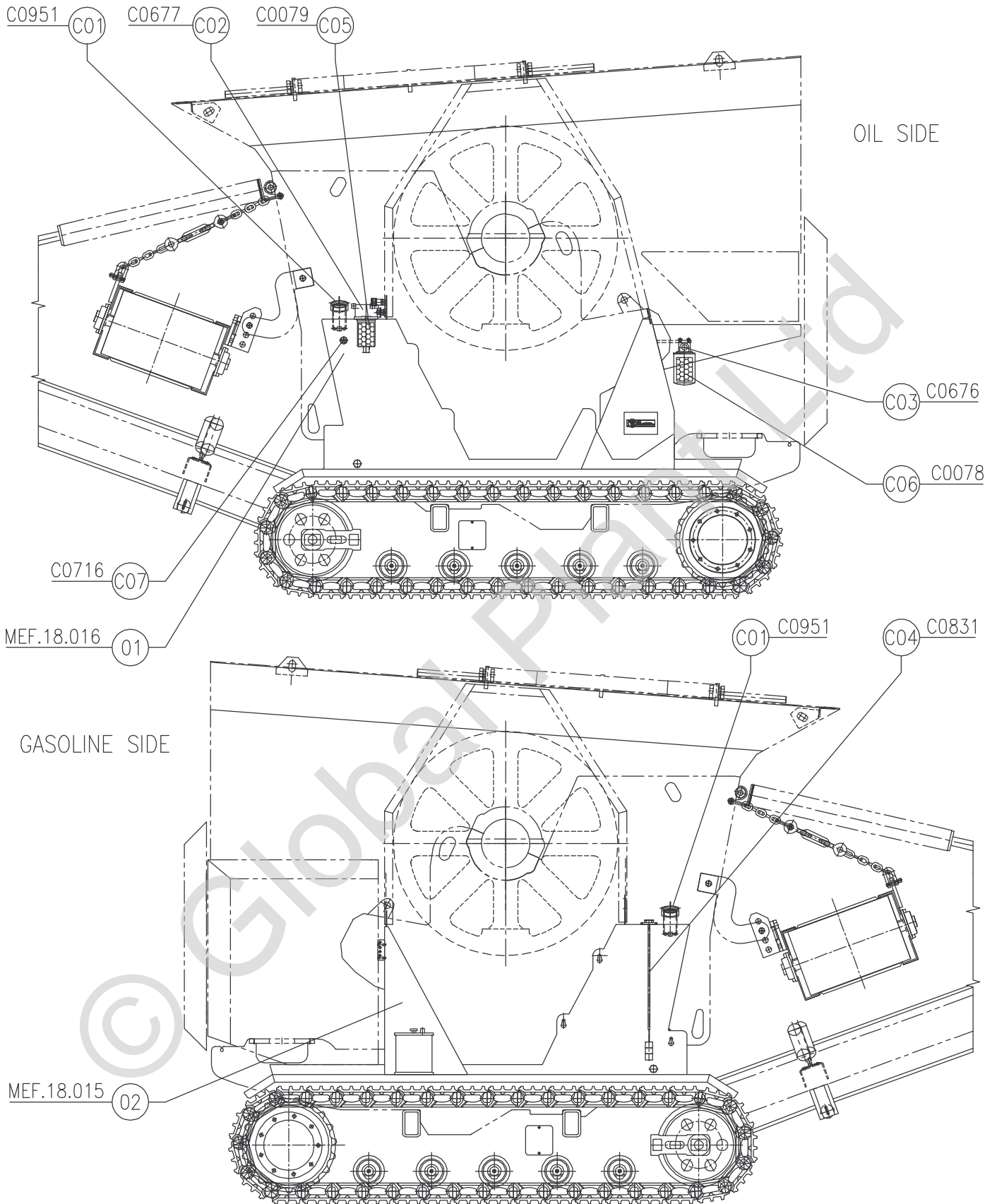

C07	C0716	LEVEL INDICATOR	1		
C06	C0078	ASPIRATION HYDRRAULIC OIL	1		
C05	C0079	RETURN OIL FILTER CARTIDGE	1		
C04	C0831	LEVEL SENSOR	1		
C03	C0676	ASPIRATION HYDRAULIC OILFILTER	1		
C02	C0677	RETURN HYDRAULIC OIL FILTER	1		
C01	C0951	OIL/DIESEL TS/C 60x2	2		
02	MEF.18.015	DIESEL TANK UNIT	1		
01	MEF.18.016	OIL TANK UNIT	1		
000	000	DESCRIPTION	QTY		REMARKS

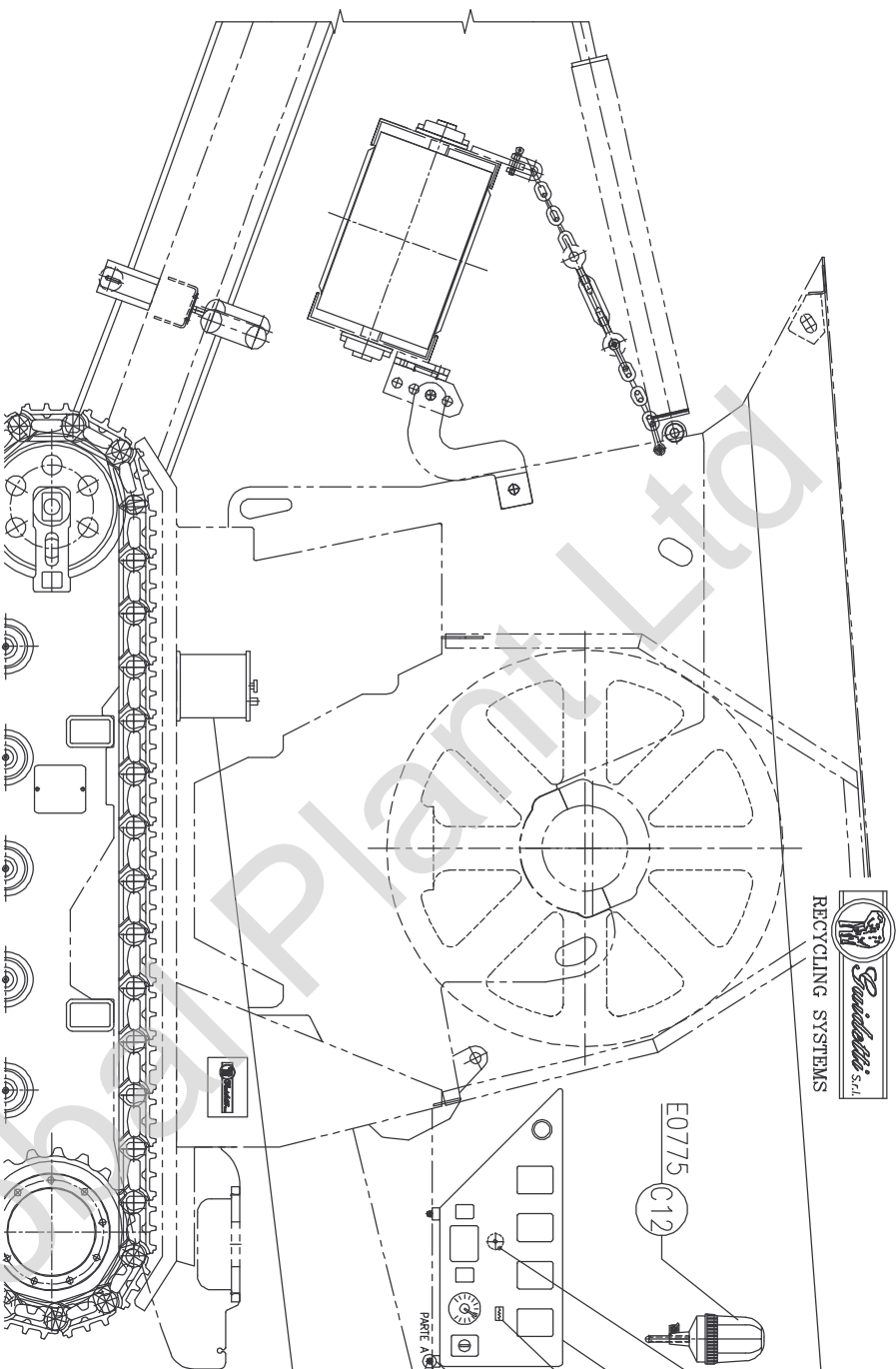

POS.	REF.	DESCRIPTION	Q.TY	EURO
C13	C0748	SPARKING PLUGS	1	
C12	E0775	WINKING	1	
C11	CV13006	NUT M8 UNI ESNorm	8	
C10	CV07001	FLAT WASHER UNI 6592B 8X17	8	
C09	C1070	ANTI-VIBRATION DUMPER M8 30x20	4	
C08	E0722	62.00.15.00 DIODO MF450	1	
C07	E0720	79.0092.00_FUSIBILE MAXI FUSE	1	
C06	E0783	ANTENNA (870MHz)	1	
C05	C0733	BATTERY 100 Ah_450 A	1	
C04	E0774	PANEL BATTERY CHARGER	1	
C03	E0714	TABLE BATTERY CHARGER	1	
C02	E0725	RADIO REMOTE CONTROL BATTERY	1	
C01	E0729	RADIO REMOTE CONTROL	1	
02	MF2.09.003	ANTI-VANDALISM PANEL	1	
01	E0773	COMPLETE CABLING MEF.520	1	

PART. A
SCALA 1:2

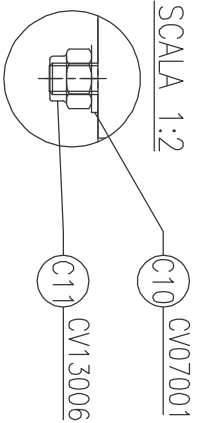

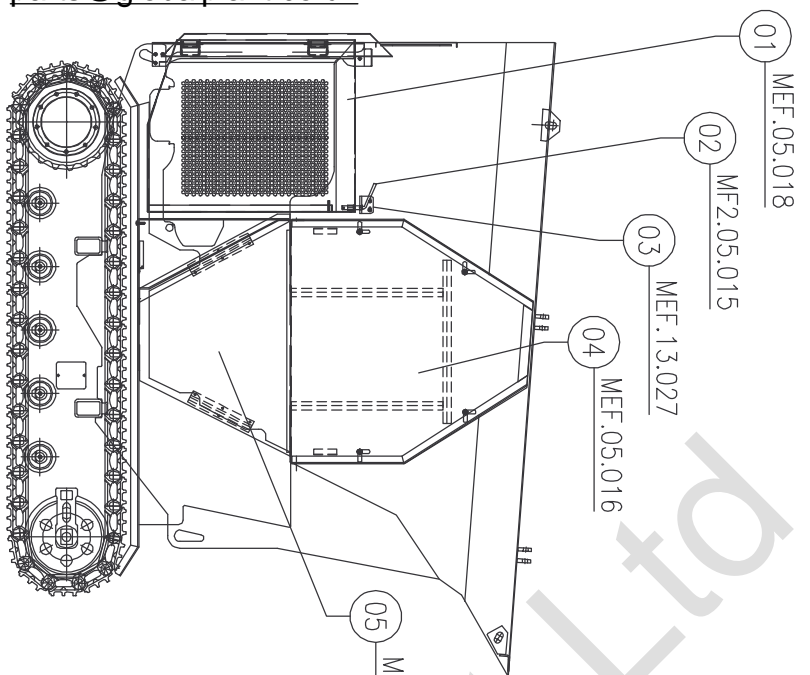

GASOLINE TANK SIDE

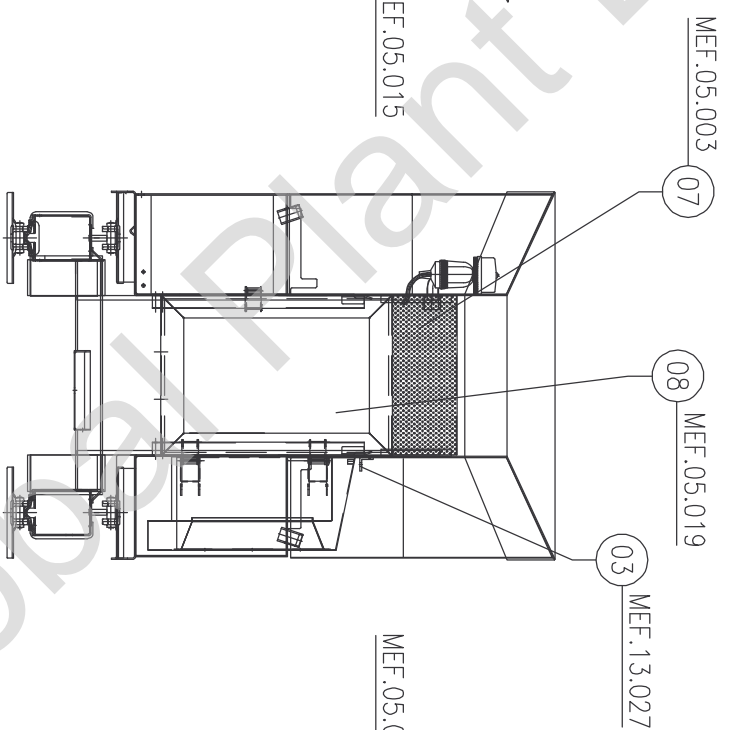

REAR SIDE (ENGINE)

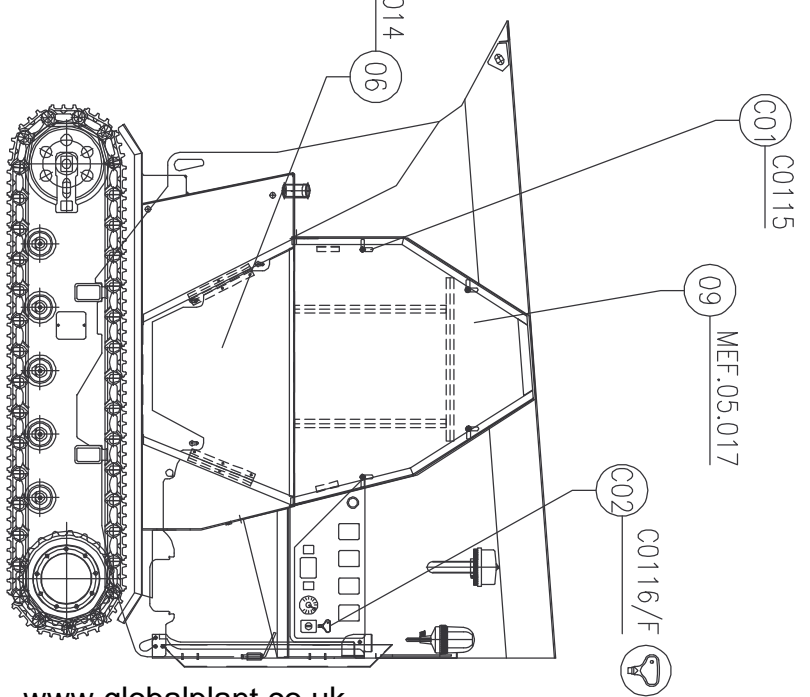

OIL TANK SIDE

C02	C0116/F	TRIANGULAR KEY FE3-3-1	2	
C01	C0115	ELECTRIC PANEL LOCK + LEVER	8	
09	MEF.05.017	HIGHER CARTER	1	
08	MEF.05.019	ENGINE COFFER UNIT	1	
07	MEF.05.003	COFFER GRID	1	
06	MEF.05.014	LOWER CARTER	1	
05	MEF.05.015	LOWER CARTER	1	
04	MEF.05.016	HIGHER CARTER	1	
03	MEF.13.027	ANGLE FOR FIXING COFFER	1	
02	MF2.05.015	LOCKING PAWL	2	
01	MEF.05.018	RADIATOR COFFER UNIT	1	
POS.	REF.	DESCRIPTION	Q.TY	EURO

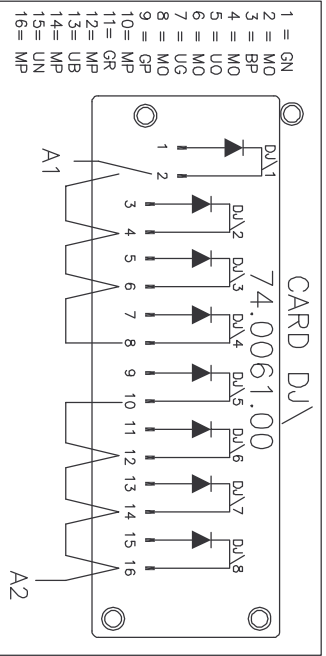
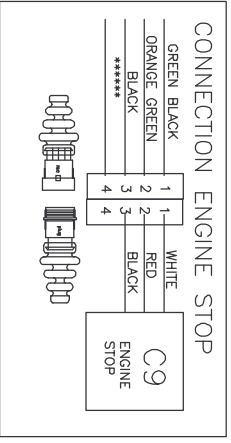
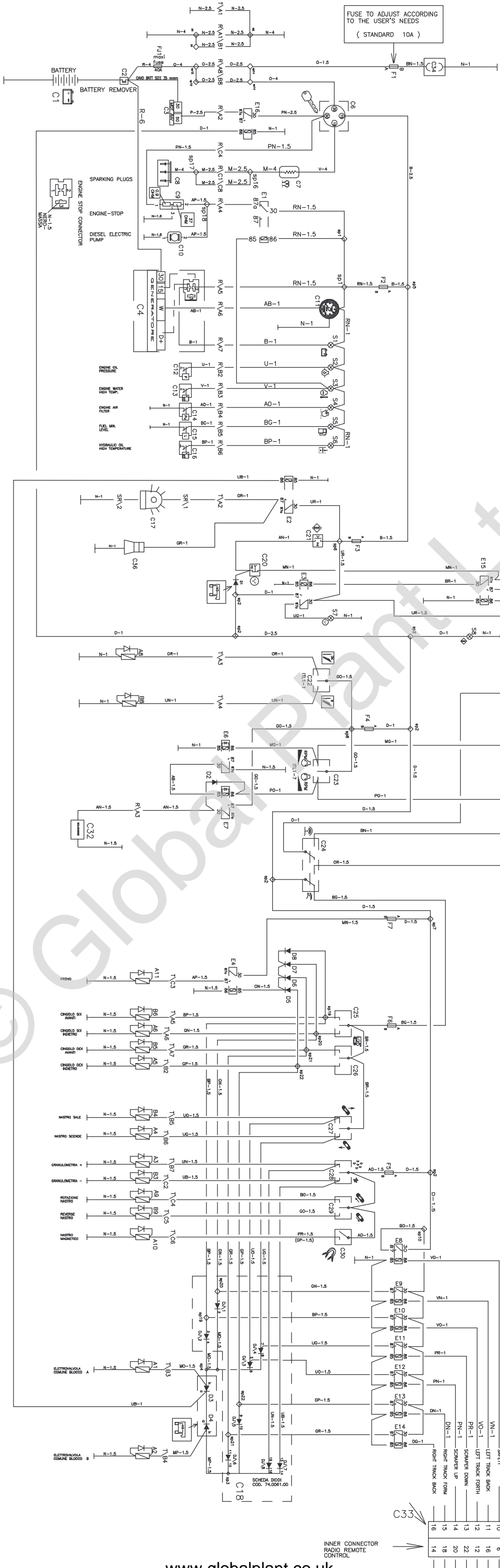
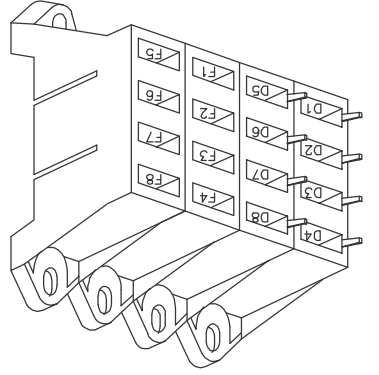

WELDED CONNECTIONS SYMBOLS		TWO-COLORED CABLES	
◇	sp CONNECTION	RN	RED BLACK
◇	CONNECTION	UP	UP GREY GREEN
◇	TOGETHER CONNECTED EARTH NEGATIVE AND SASSY	ECC.	ECC. ECC.
— —		*VO	TWO-COLORED STRIPED CABLES HAVE THE SYMBOL *
— —			VIOLLET WHITE

CABLES WITH A LINE		CABLES WITH A LINE	
SEZ. 0.5 mm	CABLES WITH A LINE	R	RED
SEZ. 1 mm	CABLES TWO LINES	N	BLACK
SEZ. 1.5 mm	CABLES WITH A LINE	A	ORANGE
SEZ. 2.5 mm	CABLES TWO LINES	B	BLUE
		V	VIOLLET
		M	BROWN
		O	WHITE
		P	GREEN
		U	ROSE
		D	GREY
		G	YELLOW

1	2	3	4	5	6	7	8	9	10	11	12	13	14	15	16												
N-1.5	WIRING	UR-1.5	POSITIVE KEY	UN-1	EMERGENCY	UP-1.5	EMERGENCY	OR-1	REMOTE CONTROL RESERVE	MO-1	POSITIVE COAST BRAKE	FO-1	ENGINE ACCELERATOR -	VO-1	SAFETY	VO-1	LEFT TRACK BACK	PR-1	LEFT TRACK FORTH	PN-1	SCRAPER DOWN	DN-1	SCRAPER UP	DN-1	RIGHT TRACK FORTH	UR-1.5	RIGHT TRACK BACK
1	1/221									2/171																	

